

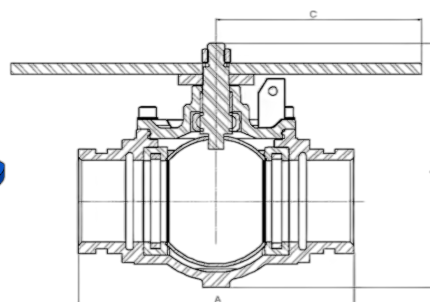

BALL VALVES - SHOULDERED

Specifications
Floating Ball Design for improved sealing and higher pressure
Bi-directional operation
Compact valve with minimum parts
Full bore design reduces turbulence and decreases pressure drop through valve
Robust cast body
Spindle designed to prevent possibility of blow out
Handles replaced easily by removing nut
Working temperature between -20°C and 80°C

Materials of Construction	
Body and Cap	Ductile Iron
Handle	Mild Steel
Spindle	Stainless Steel (SS) / Mild Steel (MS)
Seats	Reinforced, NBR
Ball	Stainless Steel
Fasteners	4.8 Carbon Nut and Spring Washer
Coating	Painted blue (RAL5005 gloss)

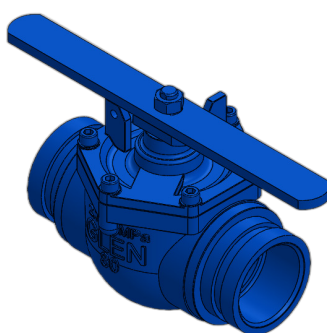

Size (mm)	Handle	Lockable	Spindle	A (mm)	B (mm)	C (mm)	Working Pressure (kPa)	Item Number
50	360°		MS	175	178	190	4000	0191232
80	360°	•	MS	255	225	195	2700	0194232
100	360°	•	SS	280	275	195	2800	0195042